

The Coach House

ST GEORGE

APPROXIMATE FLOOR AREA
67 SQM / 721 SQFT



GROUND FLOOR
344 sq.ft. (32.0 sq.m.) approx.

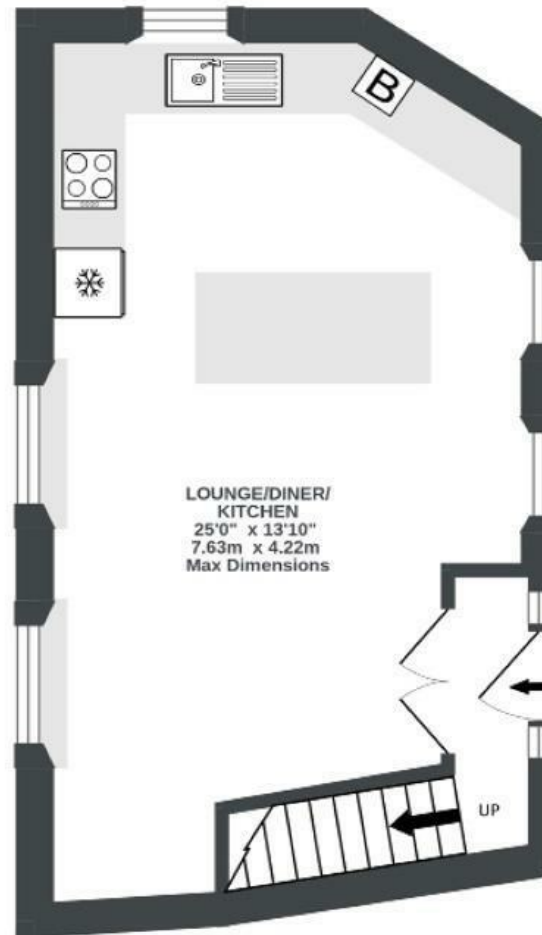

1ST FLOOR
377 sq.ft. (35.0 sq.m.) approx.

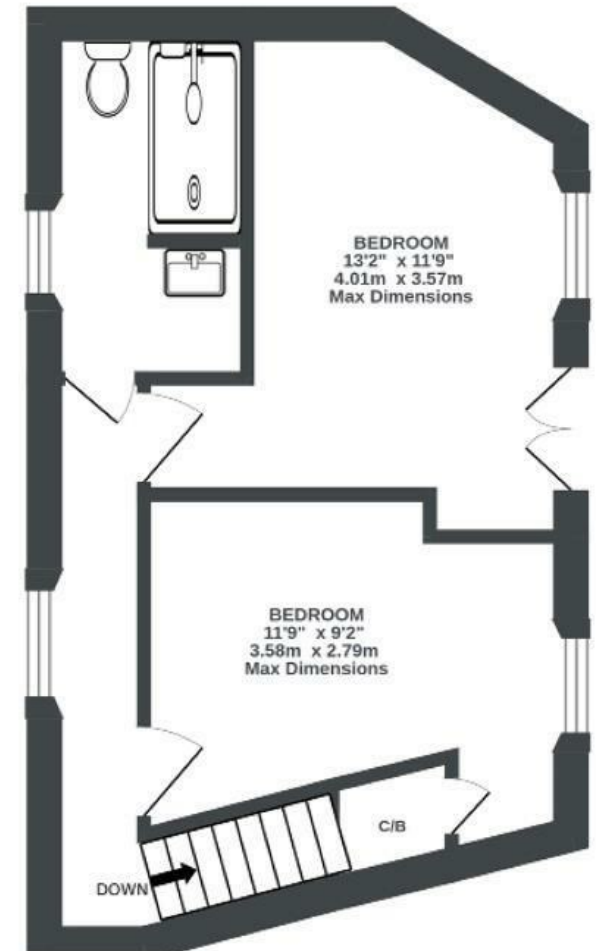

Illustrations are for reference purposes only, measurements are approximate, not to scale.

Boardwalk

Handel Avenue

ST GEORGE, BRISTOL



£300,000



2 Bedrooms



BS5 8DS



1 Bathrooms

"Since I've moved I have completely renovated the interior recently fitting a new kitchen, bathroom flooring, radiators and a new front door. It's been great living so close to St George's Park and everything on Church Road. Love going to The Red Church in the evening and how close I am to town. Bristol Loaf and Orchard Café are personal favourites."

